

Wall Hung Toilet

Set-Out Details

P-Trap : 185mm - Roughing-in from bottom of pan

4 Star - Wels 3.5 Litres Average

Vitreous China for added hygiene

Thick flat UF - Quality soft close seat with stainless steel hinges

This toilet has been built from the best available materials & has been manufactured to the highest Australian & overseas standards.

The toilet is guaranteed by the manufacturer for 1 year parts and labour and 15 years parts only. Failure to comply to these installation instructions will void this warranty.

LT-2141E-R

Rimless Wall Hung Pan

IMPORTANT

This product must be installed by a licensed plumber in order for its optimal operation and for coverage of manufacturer's warranty

All dimensions are in millimetres and are subject to normal manufacturing variations.

Paco Jaanson reserves the right to vary the specifications at any time without notice.

365mm (w) x 575mm (d) x 360mm (h)

General Information

This next generation of rimless wall hung toilet pan is eco friendly (4.5L/3L) and comes equipped with a U.F. Soft Close Seat as standard. Its simplicity of form and rimless flushing system makes it the perfect choice for any bathroom.

Maintenance

Should service be required on your toilet pan, please contact your distributor.

Cleaning Suggestions

Use only clean soap and water with a soft sponge or cloth. DO NOT USE ANY DETERGENTS OR CREAM CLEANERS.

Fixing Kit Included

For Paco Jaanson Breeze Cisterns only *



2x Spacers 2x Washers 2x Nuts

1. Measure set-out.
Mark & drill holes accordingly.

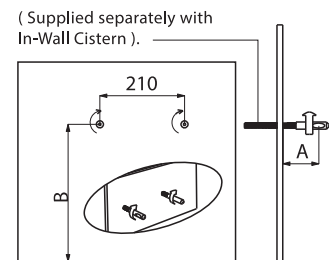
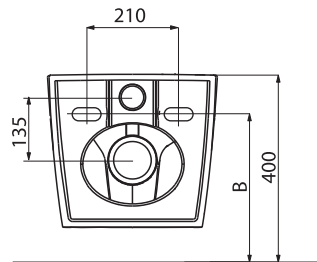
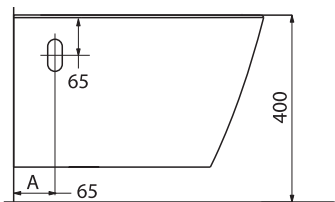

2. Place pan on rods & install fixing kit.

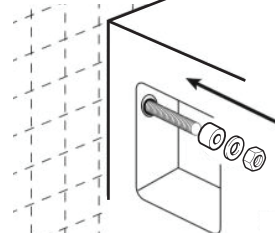
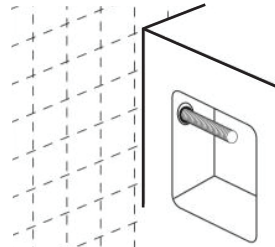
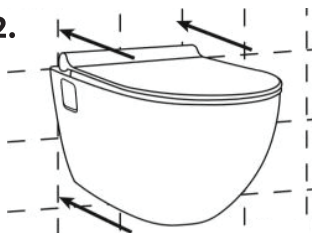

Place spacer, then washer, then nut.

3. Use tweezers to place kit on rod.

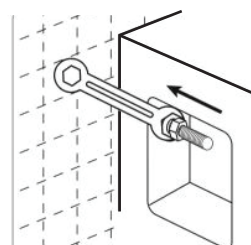
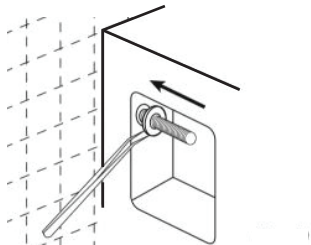

Tighten nut.

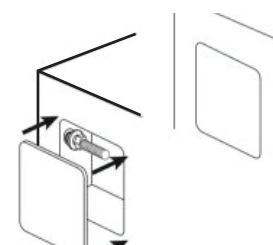

Close side cover.



* Other cistern brands may require a different size nut.

PACO JAANSON FINE BATHROOMS
Telephone : 1800 006 260
www.pacojaanson.com.au

C.1

In2change0P1102022