

paco jaanson

Projection

Wall Mount Shower Arm 340mm - Polished Chrome Finish
Product Code: HI-905A



Overall Dimensions

60mm (w) x 330mm (d) x 135mm (h)

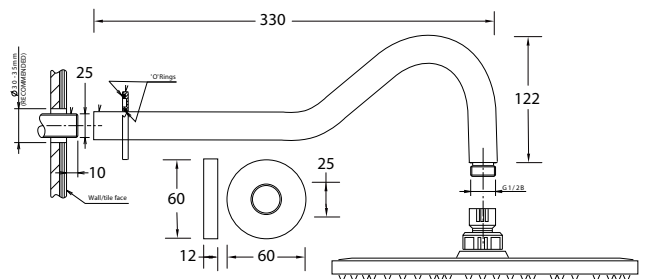

DESCRIPTION

Choosing the right shower for your bathroom is not just about good looks and design, it's also important to recognise the function you want it to perform in order to get the best possible result. It's about form + function, + the Projection Range offers something for every consideration.

This wall mount shower arm is constructed from high quality brass for long lasting durability. Its high quality finish and construction will look great in any bathroom, and its simple to install.

Distinction and magnificence emerges from the freshness of each design piece.

PRICING STRUCTURE

Retail Pricing:
Polished Chrome Finish
\$73.00 gst inclusive

Features

- High Quality Brass Construction
- Sleek Modern Design
- Polished Chrome Finish
- 1/2" Male Thread
- 7 Years Limited Manufacturers Warranty
- 1 Year Limited Commercial Warranty
- Ideal for use with Project Shower Head :

200mm Round (HI-976A)



PACO JAANSON BATHROOM INNOVATIONS
Copyright © 2018. All rights reserved. Created 17th June 2021.

Telephone : 1800 006 260
Email - info@pacojaanson.com.au
www.pacojaanson.com.au